



GOBIERNO AUTONOMO DESCENTRALIZADO DE LA PROVINCIA DE ESMERALDAS

OBRA: COLOCACION DE CARPETA ASFALTICA Y CONSTRUCCION DE CUNETAS EN EL CV QUININDE SAN RAMON - CANTON QUININDE - PROVINCIA DE ESMERALDAS

PLANIMETRIA, UBICACION DE CUNETAS Y PERFIL LONGITUDINAL
Km 12+000 - Km 13+000

DIBUJO: M. T. T. FECHA: DICIEMBRE/2017 ESCALAS: H: 1-1000 LAMINA: P-C-013

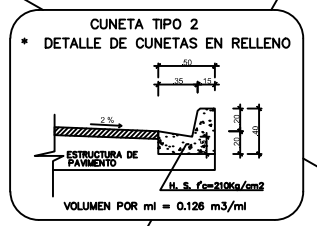
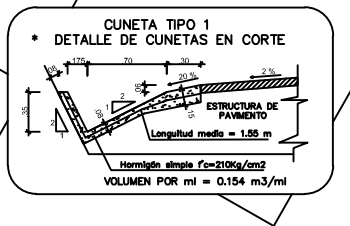

CLASIFICACION DE CUNETAS

---	CUNETAS TIPO 1
---	CUNETAS TIPO 2
---	CUNETAS TIPO 3

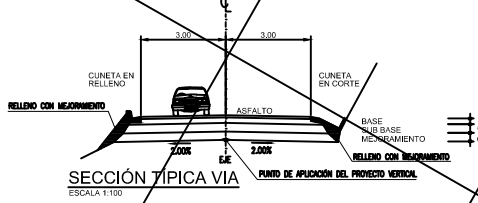

HORMIGÓN EN CUNETAS

DE	HASTA	DISTANCIA	TIPO	AREA CUNETAS m ²	VOLUMEN m ³
LADO INTERIOR					
12+000.00	12+020.00	20.00	1	0.138	0.021
12+020.00	12+040.00	20.00	1	0.138	0.021
12+040.00	12+060.00	20.00	1	0.138	0.021
12+060.00	12+080.00	20.00	1	0.138	0.021
12+080.00	12+100.00	20.00	1	0.138	0.021
12+100.00	12+120.00	20.00	1	0.138	0.021
12+120.00	12+140.00	20.00	1	0.138	0.021
12+140.00	12+160.00	20.00	1	0.138	0.021
12+160.00	12+180.00	20.00	1	0.138	0.021
12+180.00	12+200.00	20.00	1	0.138	0.021
12+200.00	12+220.00	20.00	1	0.138	0.021
12+220.00	12+240.00	20.00	1	0.138	0.021
12+240.00	12+260.00	20.00	1	0.138	0.021
12+260.00	12+280.00	20.00	1	0.138	0.021
12+280.00	12+300.00	20.00	1	0.138	0.021
12+300.00	12+320.00	20.00	1	0.138	0.021
12+320.00	12+340.00	20.00	1	0.138	0.021
12+340.00	12+360.00	20.00	1	0.138	0.021
12+360.00	12+380.00	20.00	1	0.138	0.021
12+380.00	12+400.00	20.00	1	0.138	0.021
12+400.00	12+420.00	20.00	1	0.138	0.021
12+420.00	12+440.00	20.00	1	0.138	0.021
12+440.00	12+460.00	20.00	1	0.138	0.021
12+460.00	12+480.00	20.00	1	0.138	0.021
12+480.00	12+500.00	20.00	1	0.138	0.021
12+500.00	12+520.00	20.00	1	0.138	0.021
12+520.00	12+540.00	20.00	1	0.138	0.021
12+540.00	12+560.00	20.00	1	0.138	0.021
12+560.00	12+580.00	20.00	1	0.138	0.021
12+580.00	12+600.00	20.00	1	0.138	0.021
12+600.00	12+620.00	20.00	1	0.138	0.021
12+620.00	12+640.00	20.00	1	0.138	0.021
12+640.00	12+660.00	20.00	1	0.138	0.021
12+660.00	12+680.00	20.00	1	0.138	0.021
12+680.00	12+700.00	20.00	1	0.138	0.021
12+700.00	12+720.00	20.00	1	0.138	0.021
12+720.00	12+740.00	20.00	1	0.138	0.021
12+740.00	12+760.00	20.00	1	0.138	0.021
12+760.00	12+780.00	20.00	1	0.138	0.021
12+780.00	12+800.00	20.00	1	0.138	0.021
12+800.00	12+820.00	20.00	1	0.138	0.021
12+820.00	12+840.00	20.00	1	0.138	0.021
12+840.00	12+860.00	20.00	1	0.138	0.021
12+860.00	12+880.00	20.00	1	0.138	0.021
12+880.00	12+900.00	20.00	1	0.138	0.021
12+900.00	12+920.00	20.00	1	0.138	0.021
12+920.00	12+940.00	20.00	1	0.138	0.021
12+940.00	12+960.00	20.00	1	0.138	0.021
12+960.00	12+980.00	20.00	1	0.138	0.021
12+980.00	13+000.00	20.00	1	0.138	0.021
LADO EXTERIOR					
12+000.00	12+020.00	20.00	2	0.134	0.021
12+020.00	12+040.00	20.00	2	0.134	0.021
12+040.00	12+060.00	20.00	2	0.134	0.021
12+060.00	12+080.00	20.00	2	0.134	0.021
12+080.00	12+100.00	20.00	2	0.134	0.021
12+100.00	12+120.00	20.00	2	0.134	0.021
12+120.00	12+140.00	20.00	2	0.134	0.021
12+140.00	12+160.00	20.00	2	0.134	0.021
12+160.00	12+180.00	20.00	2	0.134	0.021
12+180.00	12+200.00	20.00	2	0.134	0.021
12+200.00	12+220.00	20.00	2	0.134	0.021
12+220.00	12+240.00	20.00	2	0.134	0.021
12+240.00	12+260.00	20.00	2	0.134	0.021
12+260.00	12+280.00	20.00	2	0.134	0.021
12+280.00	12+300.00	20.00	2	0.134	0.021
12+300.00	12+320.00	20.00	2	0.134	0.021
12+320.00	12+340.00	20.00	2	0.134	0.021
12+340.00	12+360.00	20.00	2	0.134	0.021
12+360.00	12+380.00	20.00	2	0.134	0.021
12+380.00	12+400.00	20.00	2	0.134	0.021
12+400.00	12+420.00	20.00	2	0.134	0.021
12+420.00	12+440.00	20.00	2	0.134	0.021
12+440.00	12+460.00	20.00	2	0.134	0.021
12+460.00	12+480.00	20.00	2	0.134	0.021
12+480.00	12+500.00	20.00	2	0.134	0.021
12+500.00	12+520.00	20.00	2	0.134	0.021
12+520.00	12+540.00	20.00	2	0.134	0.021
12+540.00	12+560.00	20.00	2	0.134	0.021
12+560.00	12+580.00	20.00	2	0.134	0.021
12+580.00	12+600.00	20.00	2	0.134	0.021
12+600.00	12+620.00	20.00	2	0.134	0.021
12+620.00	12+640.00	20.00	2	0.134	0.021
12+640.00	12+660.00	20.00	2	0.134	0.021
12+660.00	12+680.00	20.00	2	0.134	0.021
12+680.00	12+700.00	20.00	2	0.134	0.021
12+700.00	12+720.00	20.00	2	0.134	0.021
12+720.00	12+740.00	20.00	2	0.134	0.021
12+740.00	12+760.00	20.00	2	0.134	0.021
12+760.00	12+780.00	20.00	2	0.134	0.021
12+780.00	12+800.00	20.00	2	0.134	0.021
12+800.00	12+820.00	20.00	2	0.134	0.021
12+820.00	12+840.00	20.00	2	0.134	0.021
12+840.00	12+860.00	20.00	2	0.134	0.021
12+860.00	12+880.00	20.00	2	0.134	0.021
12+880.00	12+900.00	20.00	2	0.134	0.021
12+900.00	12+920.00	20.00	2	0.134	0.021
12+920.00	12+940.00	20.00	2	0.134	0.021
12+940.00	12+960.00	20.00	2	0.134	0.021
12+960.00	12+980.00	20.00	2	0.134	0.021
12+980.00	13+000.00	20.00	2	0.134	0.021

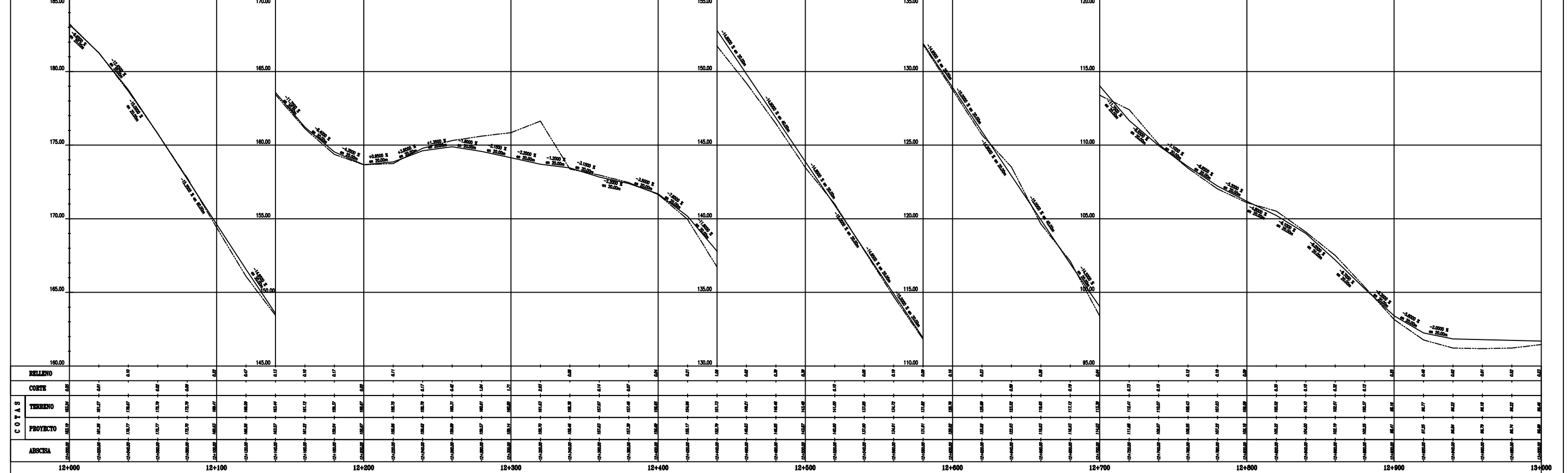
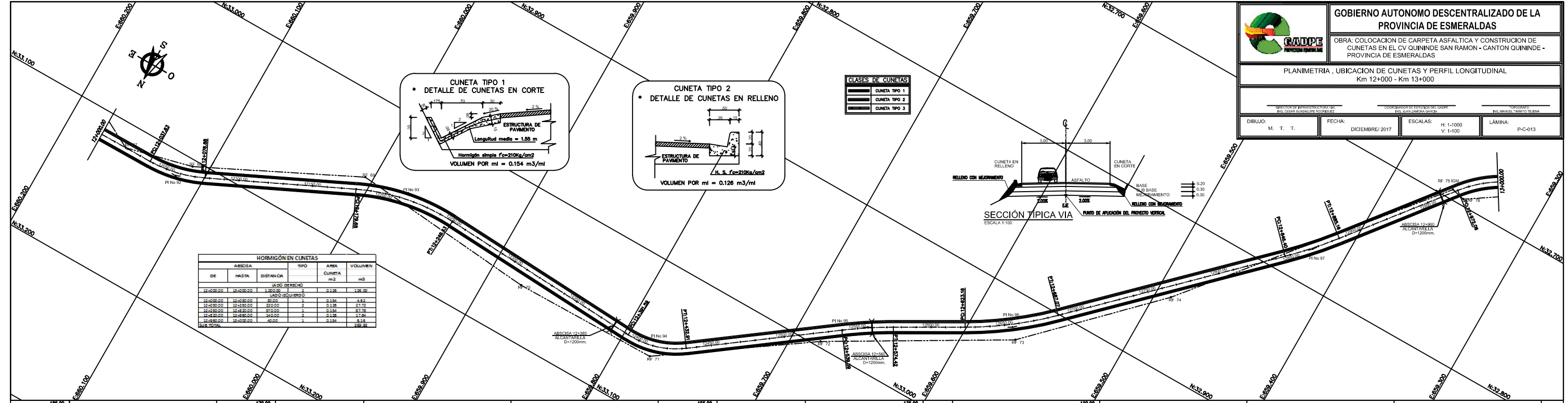

COTAS	RELLENO		CORTE		PROYECTO	ABSCISA
	DE	HASTA	DE	HASTA		
	160.00	170.00	170.00	185.00		12+000
						12+100
						12+200
						12+300
						12+400
						12+500
						12+600
						12+700
						12+800
						12+900
						13+000